

Title I, Part A Monitoring

join.nearpod.com



Check In = Rose, Bud, Thorn

Check in: Name something you are enjoying or have enjoyed this summer; something in the near future you are excited about; or something in the near future you are not looking forward to.

Instructions

A screenshot of a digital collaborative board interface. At the top, there are three columns with headers: "Rose = Enjoying", "Bud = Anticipating", and "Thorn = Dreading". Each header has a trash icon. To the right is a blue "Add Column" button. Below the headers are three cards. The first card shows a red rose. The second card shows a pink rose bud. The third card shows a purple thorn. A blue circular icon of a notepad with a pin is overlaid on the middle card. The text "Collaborate Board" is written in large blue letters across the bottom of the cards. Each card has "Teacher" and a three-dot menu icon in the top left corner.

Check In = Rose, Bud, Thorn

Monitoring may seem like...



Learning Intention

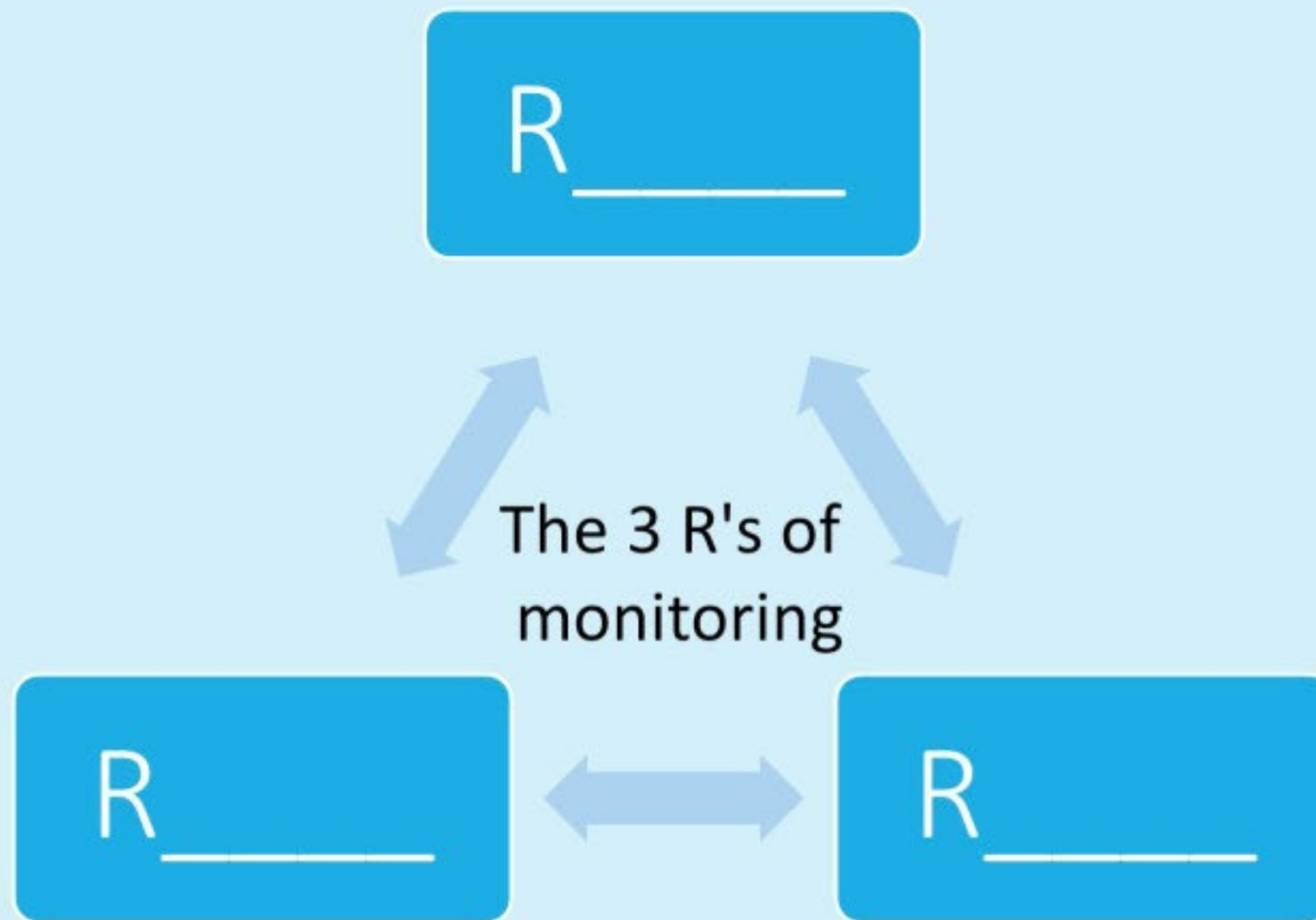



The Three R's of Monitoring

Take a guess...when it comes to the purposes of Title I monitoring, what is one of the R's?

^ Instructions



Collaborate Board

The Three R's of Monitoring

Learning Intention

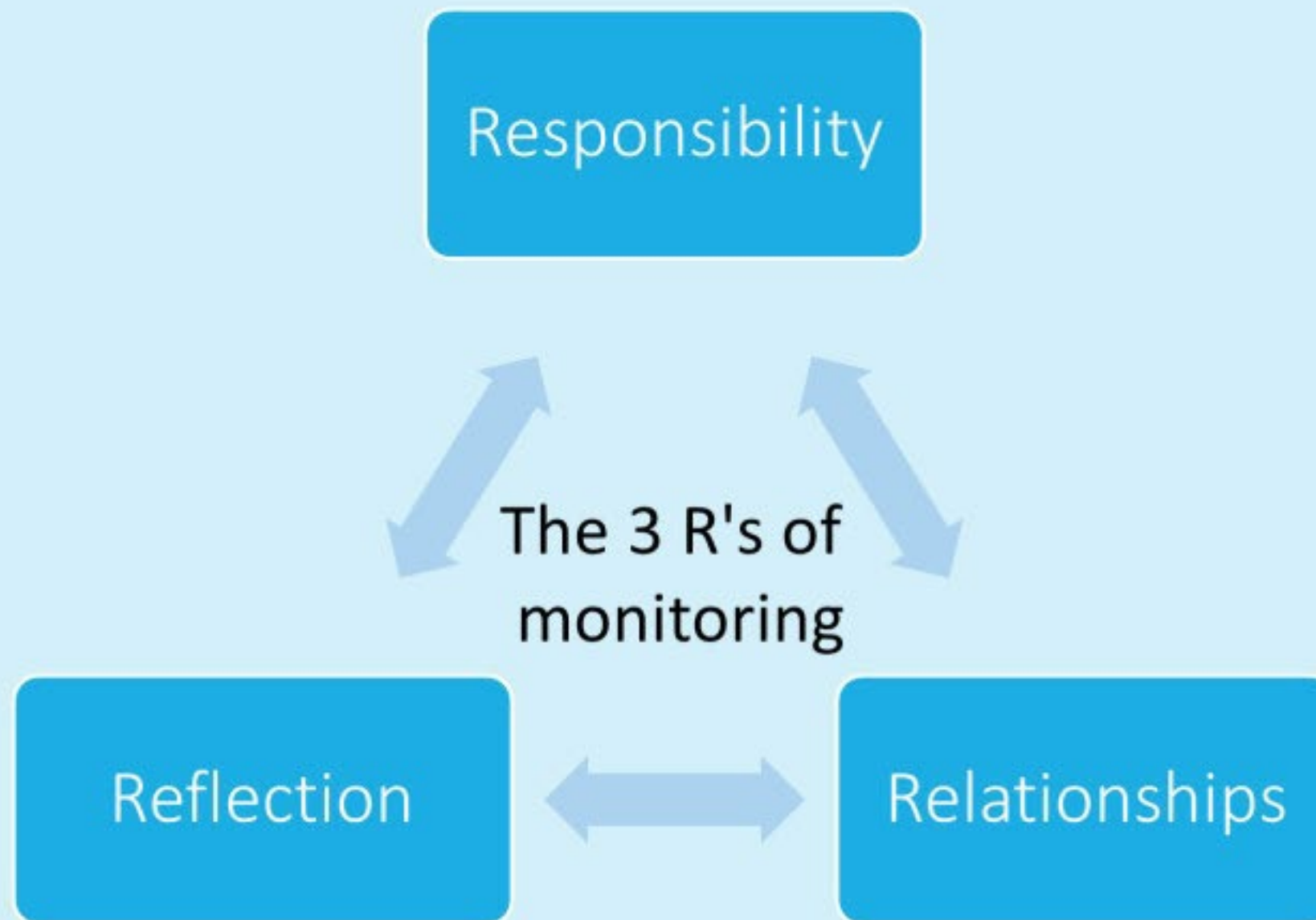

Success Criteria



Differentiate between desktop, routine visit, and high-risk monitoring



Identify Title I requirements your LEA and school(s) should address now



Determine which of the supports you will access to complete this year's DMI





Title I, Part A Monitoring



DESKTOP MONITORING
(ANNUALLY)



ONSITE/VIRTUAL
MONITORING
(5-YEAR ROTATION)



Annual Desktop Monitoring

Utah Grants Management System

Desktop Monitoring Instrument (DMI)



Utah Grants Management System



To be completed by November 1st

Help Desk
utahgrants@schools.utah.gov
801-538-7604



Desktop Monitoring Instrument (DMI)



Utah State Board of Education - Desktop Monitoring Instrument

E-mail Address:

Password:

[Reset Password](#)
[First-time user? Accept Invitation](#)

If you have trouble logging in, please contact
dmi.helpdesk@schools.utah.gov

DMI Technical Support

- Recorded Training** posted to YouTube (link will be sent out)
- New Title I Directors Cohort** 9/15 8-9am & 3-4 pm (via Zoom)
- Office Hours** 9/27 1-2 pm (after Title I Directors meeting via Zoom)
- Due** December 1st



<https://dmi.schools.utah.gov/Tracker/Security/Login.aspx>



DMI is...



DMI – Annual Responsibility

Instruments

Annual Core
(core items)

Cycle
(4 rotating)



DMI - Annual Core Documentation (Uploads)

Working link to LEA report card posted on the LEA's website

Family Engagement LEA Self-Reflection

Documentation of the current year's annual Title I meeting

Summary of LEA's process to contact private schools (district LEAs)

Affirmation of Consultation with private schools (districts LEAs)

Supplement Not Supplant Methodology (if updated)

Title I Comparability Report (districts and multi-site charters)



DMI - Annual Core Documentation





MURRAY CITY SCHOOL DISTRICT We Are Murray!

- Grant Elementary Horizon Elementary Liberty Elementary Longview Elementary McMillan Elementary Parkside Elementary Viewmont Elementary ECEC Hillcrest Jr. High Riverview Jr. High Murray High Community Education

Calendar

First Day of School 7th Grade Only August 18

First Day of School for Kindergarten August 28

Labor Day - No School

Utah School Report Card

The Utah State Board of Education posts the report cards of each school



You can locate other districts/school report cards by clicking here and selecting the district you are interested in.



https://www.murrayschools.org/proof-of-residency/utah-school-report-card/



Our Results

Just as your child's report card shows how your child is performing, these school report cards show you how your child's school is performing in multiple areas.

Parents are critical partners in our school's success.

Using the links below, you can see how our school is doing in comparison to other schools! Data is collected and summarized by the Utah State Board of Education.

They are designed to show our school's strengths and areas in need of improvement in order to ensure our schools are meeting the needs of all students.

[Learn More](#)

<https://entheosacademy.org/our-results>

FIRST DAY OF SCHOOL - - The first day of school for the 2023-24 school year begins August 15, 2023. WELCOME BACK!



[Calendars](#) [School Board](#) [Policy](#) [Forms](#) [Letters](#) [District Jobs](#) **SAFE UT**

WASHINGTON COUNTY
SCHOOL DISTRICT



Search here...



[Home](#) [Students & Parents](#) [Departments](#) [Schools](#) [District](#) [Employees](#)



School Board



Routes & Boundaries



Student Meals



District Calendars



Emergency Plan



PowerSchool Info



Curriculum Adoption



Student Scholarships



Strategic Plan



District Jobs



Learn how we're
balancing our budget



BALANCED BUDGET

DETAILS

<https://www.washk12.org/>



Child Nutrition Program

Common Sense Nutrition for a Healthy Future

English



CALENDAR

August

TUESDAY - AUG. 15, 2023

First Day of School - 2023-24 School Year

DMI – Cycle Documentation (Uploads)

Cycle 4: School-Level Programs

Schoolwide Plan
& Comprehensive
Needs Assessment

Targeted Assistance
Program
Components





What to Addressed Now?

Title I Year-at-a-Glance

Annual Title I Meeting – **Include all required components**

LEA Family Engagement Policy (see Cycle 3 of DMI from 2022-23)

School Family Engagement Policy (see Cycle 3 of DMI from 2022-23)

School-Family Compact (see Cycle 3 of DMI from 2022-23)

Parents Right to Know (see Cycle 2 of DMI from 2021-22)

Title I school-level Plan/Program

IT request for website updates





Lake View Elementary
Home of the Leopards

LAKE VIEW ELEMENTARY // PARENTS // TITLE 1

Title 1 Information

What is Title I?

Title I is a federal education program under the Elementary and Secondary Education Act (ESEA) of 1965, which schools provide supplemental educational services to meet the needs of disadvantaged students.

What are the Goals of Title I?

1. Help students to achieve academic success in Reading/Language Arts and Mathematics
2. Increase student performance in high poverty schools through school-wide reform
3. Enhance parents' abilities to help their children succeed through quality parental involvement activities

Annual Title 1 Information for Parents (Coming Soon)

Title 1 Coordinator: Heidi Jo West

Parent-School Learning Compact

[Title 1 - Compact Presentation](#)

[Parent/school/student compact](#)

[Compacto de Padres/Escuela/Estudiantes](#)

Parent Engagement Policy

[Parent Engagement Policy](#)

[Política de Participación de Padres](#)

School
websites
might
include...

TITLE I NEW DIRECTORS



Utah State Board of Education



Lake View Elementary

Home of the Leopards

School
websites
might
include...

Additional Resources

[Right to Know](#)

[Annual Title 1 Meeting Slides](#)

[Presención de Reunión Anual de Título 1](#)

[Title 1 Parent Meeting Presentation](#)

[School Report Card - Link](#)

[Compare Schools - Link](#)

Title 1

Parents,

These are documents and statements that pertain to the Federal Title I Program and its application at Lake View Elementary. If

Sincerely,

Mr. Morris, Principal

Lake View Elementary Title I School Program Summary 2022-2023

What is Title I?

Title I is a federal program that provides funding for some public schools. The number of students in a school receiving free and Elder School District that receive this assistance. This funding is in addition to the regular funds provided to all public schools.

What Does It Pay For?

The restricted personnel budget is earmarked for a specific purpose. It pays for the salary and benefits of 5 employees:

- Full-Day Kindergarten Teacher
- Full-Day Kindergarten Aide
- Instructional Paras



Provide Title I Information in Multiple Ways





Title I, Part A Monitoring



DESKTOP MONITORING



ONSITE/VIRTUAL
MONITORING



Monitoring Visits



Monitoring visit for LEAs during 2nd year of utilizing funds



Routine monitoring visit every 5-ish years



Monitoring visit based on risk





Title I Virtual/Onsite Monitoring



PROGRAMMATIC



FISCAL



Monitoring Visits 23-24

Beaver SD
Box Elder SD
Duchesne SD
Morgan SD
North Summit SD
Park City SD
Sevier SD
Am. Academy of Innovation
American Prep. Academy
Ascent Academies
Bear River Charter
Bonneville Academy
Canyon Grove Academy
Center for Creativity...

Channing Hall Academy
Good Foundations
Guadalupe School
Intech HS
Jefferson Academy
Lakeview Academy
Leadership Academy UT
No. Davis Prep. Academy
Ogden Prep. Academy
Promontory School
Syracuse Arts Academy
Treeside Academy
Valley Academy
Walden Sch. Liberal Arts

Interviews

LEA
Administration

School
Administration

Programmatic Monitoring



High-Risk Monitoring Visits

An LEA may be considered for technical assistance and/or monitoring for the following reasons:

1. Verified risk score is in the top 10 highest
2. Failed to resolve findings from a previous monitoring visit.
3. Had extensive findings from a previous monitoring visit and a follow-up is needed to ensure resolution.
4. Showed evidence of serious or chronic compliance problems.
5. Waived funds in the past.
6. Received complaints from parents and/or other stakeholders about program implementation.
7. Failed to respond to USBE requests for documentation and/or action.





Support / Technical Assistance

Ongoing Support

- Year-at-a-Glance (hyperlinks)
- Call or email
- Visit USBE website

New Title I Directors

- Held yearly, usually in August
- New TI Directors' Cohort:
 - ⑩ 6 sessions – 8/31, 9/15, 10/4, 11/1, 1/10, 2/28 (2 sessions/day)

Title I Directors Meetings

- Sept. 27th
- Nov. 30th
- March 28th

DMI Training

- **Recorded training** posted to YouTube by September 1st
- Sept 15th **New TI Directors' Cohort** focused on DMI (8am or 3pm)
- Sept 27th **Office** hours – 1:00-2:00 pm



Success Criteria



Differentiate between desktop, routine visit, and high-risk monitoring



Identify Title I requirements your LEA and school(s) should address now



Determine which of the supports you will access to complete this year's DMI



Poll



Which support(s) will you access to complete the Desktop Monitoring Instrument (DMI)? (click all that apply)

- Watch the DMI training video which will be posted to YouTube by the first week in September**
- Attend the September 15th New Title I Directors Cohort**
- Show up for the DMI Office Hour(s) from 1-2pm on September 27 (after the Title I Directors Meeting)
- Call/email Val way before the December 1st due date**
- None, no support is needed - I can complete the DMI in my sleep/nightmares

Monitoring =
Regular checkups
Responsibility +
Relationships +
Reflection

TITLE I NEW DIRECTORS



Utah State Board of Education

Inquiry / Discovery

Please post one or more questions you have and/or one or more things you learned related to Title I monitoring

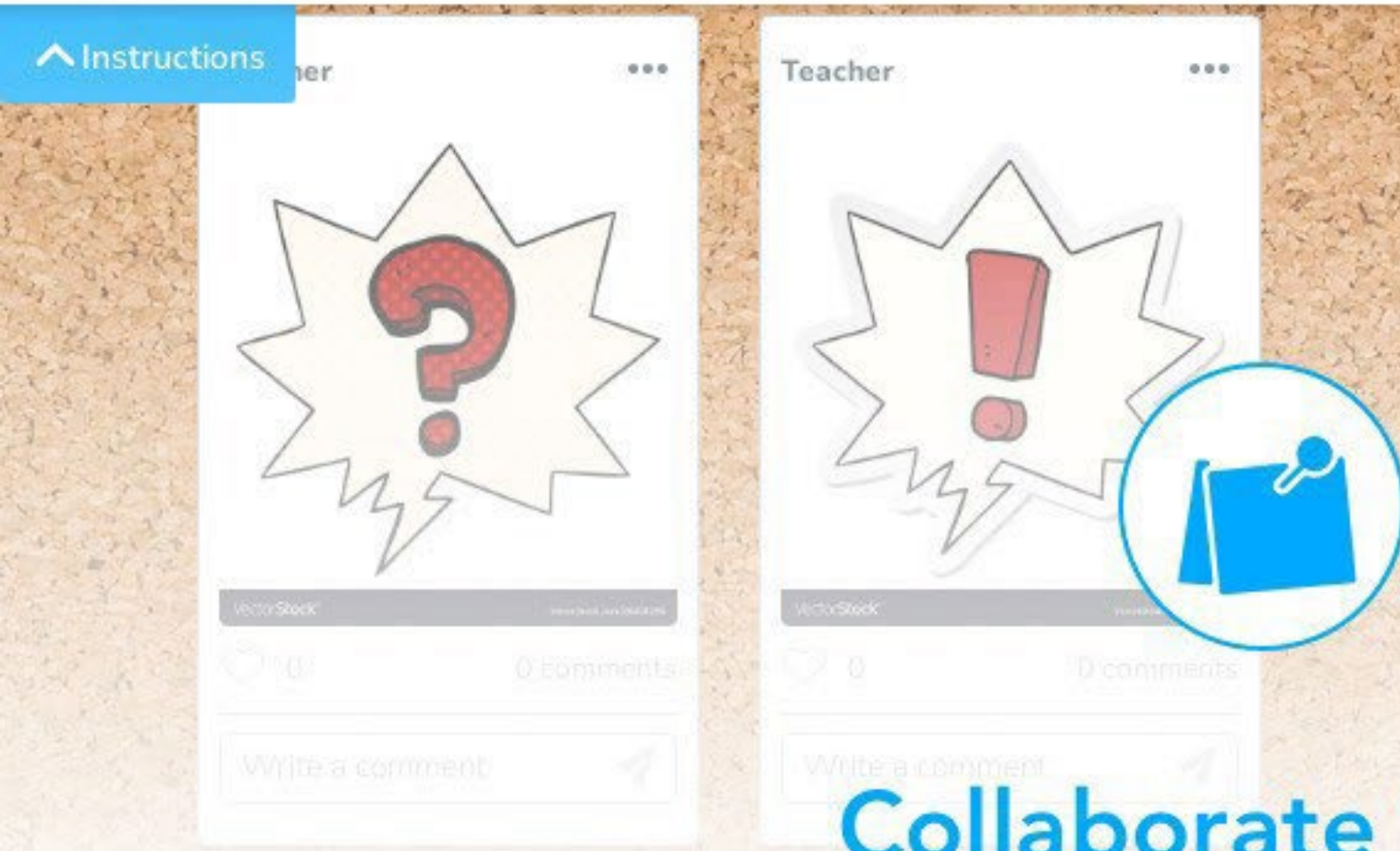

Collaborate Board

Inquiry / Discovery